

# PAROLE & PROBATION DIVISION



Presenters: Greg Rikhoff, Director of Operations  
Donovan Dumire, Manager  
Lynn Smith, Accounting Analyst

# Parole & Probation Overview

## *Mission:*

To improve the quality of life in Lane County by effectively responding to risk, need and promoting positive change.

- Community Supervision (Reduced, Moderate and High Risk)
- Specialized Supervision:
  - Sex Offender
  - Domestic Violence
  - Treatment Court
  - Mental Health
  - Gender Specific
  - 416- Downward Departures
- Transition Services- Alternative Incarceration Program
- Re-entry Lane (RLAN) Program
  
- 59 FTE



# Current Year Budget Changes

Since FY 17-18 Budget Adoption, the following changes to the Department budget have occurred:

- 17-19 Biennium:
  - Increase in Community Corrections Act (CCA) revenues
  - Increase Justice Reinvestment Grant Program (JRGP) revenues.
  - Increased staff by 1.0 Office Assistant, 1.0 Corrections Tech, 2.0 Parole Officers and 1.0 Supervisor.



# FY 18-19 Budget Details

## 18-19 RESOURCES

- Community Corrections Act funds
- Justice Reinvestment Grant Program
- Supervised Probationer Fees
- Grants
- Sheriffs Office – General Fund

- Type of Fund:

Special  
Revenue  
Funds  
100.00%

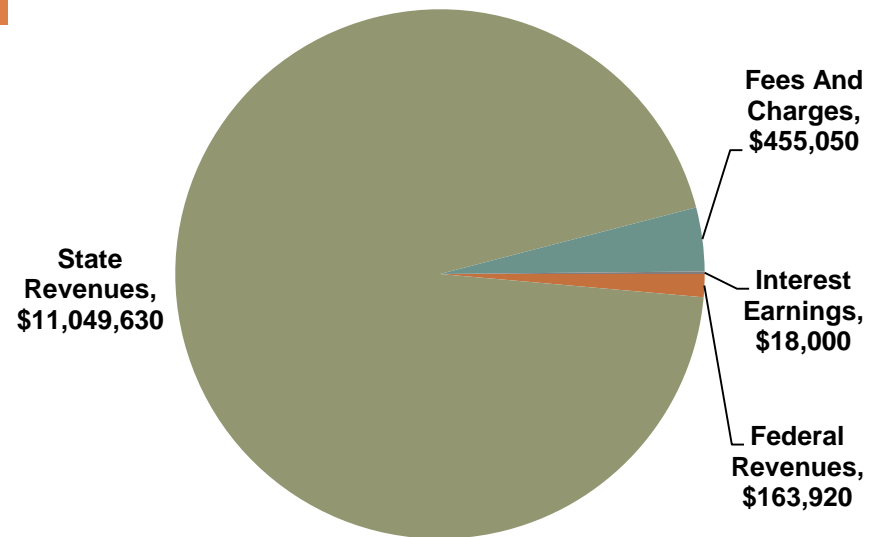
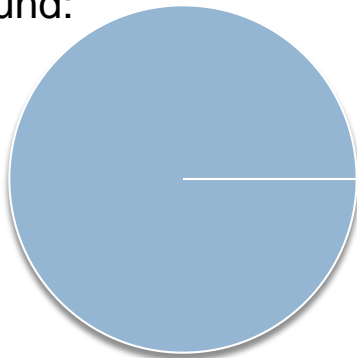

# FY 18-19 Budget Details

## 18-19 EXPENDITURES

- Despite additional staff, participation in Vacancy Variance Process has maintained our personnel costs.
- Reduced our computer workstations by about ½ to reduce costs.

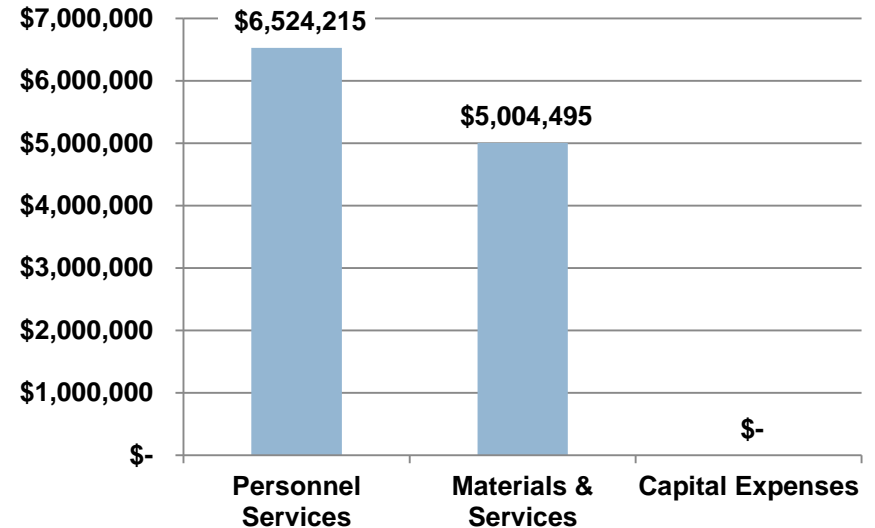

# Overall Budget

Total Budget: \$13,774,376

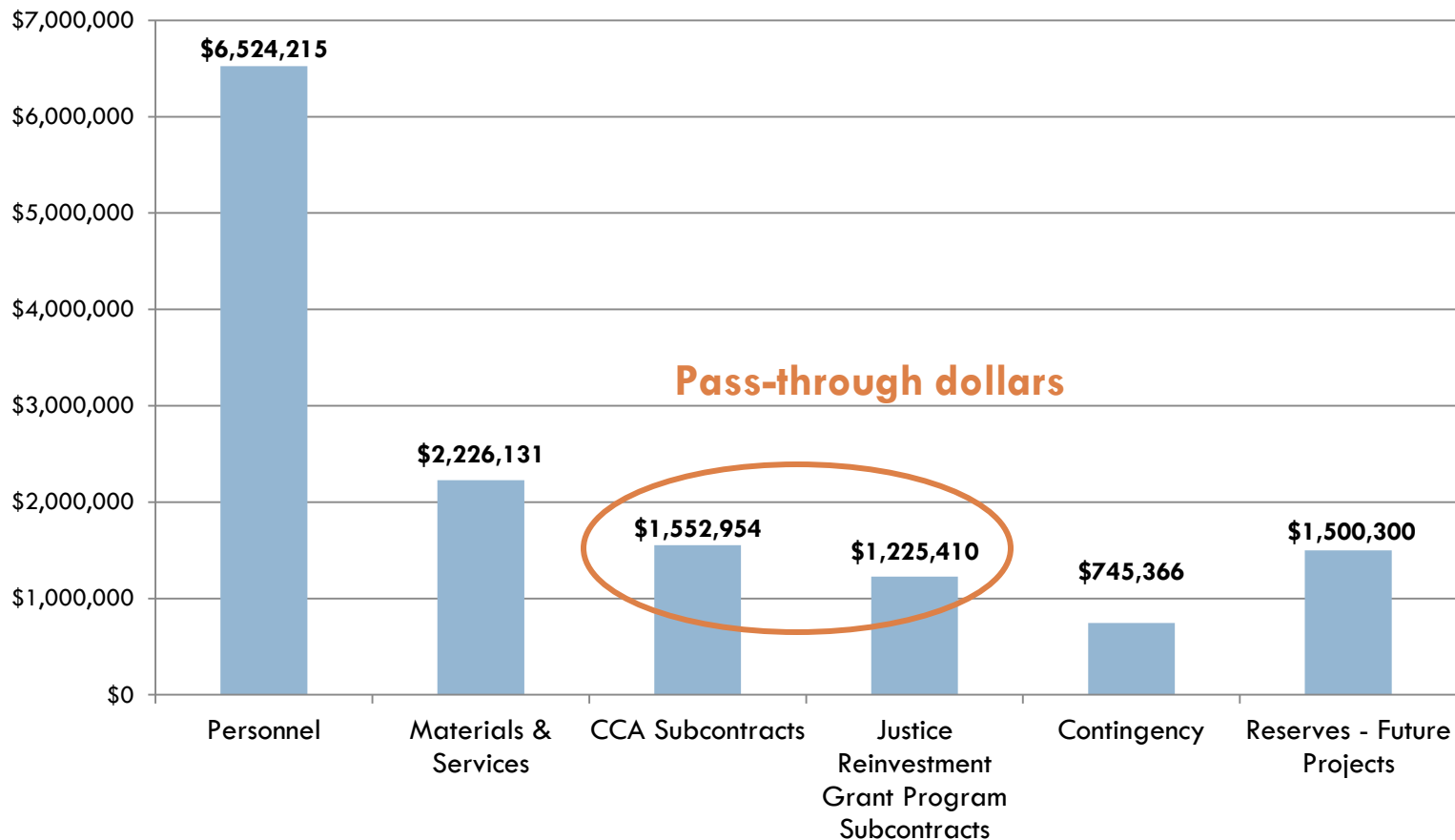

FY 18-19 Proposed Budget Presentation



# Partnerships

- Lane County Sheriff's Office, Eugene PD and Florence PD
- District Attorney's Office
- Health and Human Services (Behavioral Health Division)
- Homes For Good Housing Agency (HACSA).
- Sponsors
- Emergence
- Department of Public Safety Standards and Training (DPSST)
- Department of Corrections (DOC)
- Oregon Association of Community Corrections Directors (OACCD)  
& affiliated statewide committees



# Highlights of FY 17-18 Outcomes

New Supervisor  
Greetje  
Brunsmann

Justice Involved  
Women's  
Initiative

Crisis Intervention  
Response Team



Modeling PTO to  
agencies in/out  
of Oregon.

LCSO  
Sherman Center  
PO Kim Bowman

Policy Development  
Phase 3 of 4

Progress towards  
Relocation Efforts





# Future Challenges & Opportunities

- *Parole & Probation is working on relocation efforts to address space concerns at our current location (Community Corrections Center – 2<sup>nd</sup> Floor).*
- *Developing a new outstation – Jacob's Lane Justice Involved Women's Office.*

Community Supervision Levels	High	Medium	Low
<b>Lane</b>	<b>1546</b>	<b>788</b>	<b>539</b>
Clackamas	578	859	683
Marion	723	914	1474
Washington	859	1028	1290

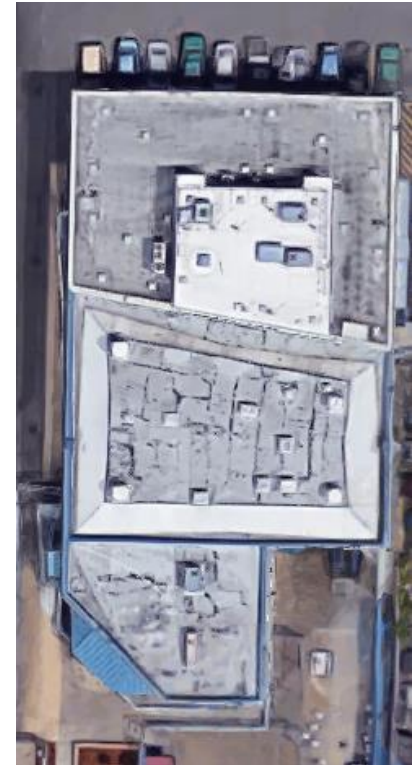



# Lane County Strategic Plan

## Safe, Healthy County

- Justice Involved Women's Initiative  
Gender Specific Risk/ Needs
- Florence Jail Beds  
Swift Sanctions
- Assigned LCSO PO  
Alternative Programs
- Pay For Success  
Housing Initiative

## Vibrant Communities

- Reduce Risk/ Needs.  
Improve the quality of life
- Assist in developing  
healthy families and  
community members

## Robust Infrastructure

- Pursue a new  
location for Adult  
Parole and Probation
- Renovate current  
Parole and Probation  
space to return  
facility to an  
operational  
Community  
Corrections Center

## Our People & Partnerships

- Sherman Center  
Alternative Programs  
-LCSO
- Pay for Success  
-Sponsors  
-Homes For Good
- Prison Diversion  
-DA's Office  
-LCSO  
-Sponsors
- RLAN Program  
-Sponsors  
-LCSO  
-DOC



# Questions?

11

- *Up Next: H&HS- Behavioral Health and Youth Services*

